

# Installation Instructions: Emergency Pack (11478)

Date

5.7.24

1



Read these instructions before installation and retain for future reference This equipment should be installed by a competent electrician

## Important Information

We recommend that luminaires are installed by a qualified electrician ensuring the installation complies with current IEE wiring regulations BS7671:2018 & local building control.

- BELL will not accept responsibility for any claims arising from a poor installation.

## Important User Advice

- Temperature range 0°C - 50°C.
- Ensure that there is adequate free air ventilation around the fitting.
- Always switch off mains supply before installing.

This product may contain substances that can be hazardous to the environment if not disposed of properly. Electrical and electronic equipment should never be disposed of with general household waste but must be separated for its correct treatment and recovery. Where possible recycle your packaging.

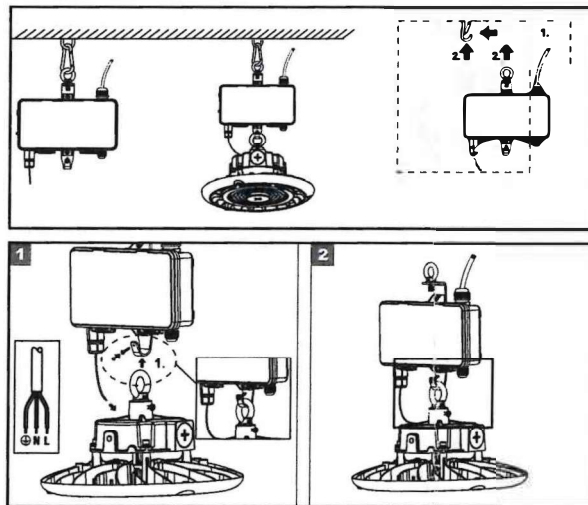
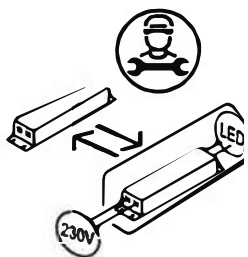

## Function

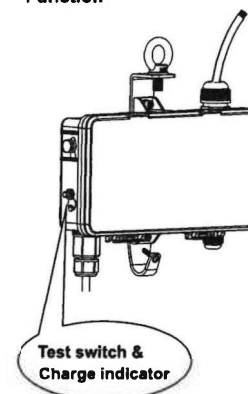

### 1. Auto-test function:

When AC main power is in fault or blackout, the unit will switch to emergency mode automatically.

### 2. Initially auto-test setting:

When the unit is connected to the AC main power correctly, it will conduct the initial test. If there is any abnormality indicator light will flash quickly and will resume to normal status once the abnormality is corrected.

### 3. Auto-test settings after installation:

- The first automatic monthly test will be conducted within 24 hours and monthly test will be conducted every 30 days thereafter. If there is a power failure during the course, the timing will be restarted. The simulated emergency time is about 60 seconds per month.
- After the initial power-on, an annual automatic test is performed every 52 weeks. After the device is initially energized and fully charged for 24 hours, an annual automatic test is performed every 52 weeks, and the timer starts again if there is a power failure in the middle of the test.
- In emergency mode, the green indicator shows a breathing mode (flickering on and off), and at the end of the timer, the power supply can be switched to the charging mode (green indicator blinks slowly). The green indicator flashes slowly. The battery voltage must not fall below the over-discharge protection value. If low voltage occurs, the battery is severely depleted and needs to be replaced. (If the battery voltage is low, the battery is severely depleted and needs to be replaced, and a red fast-flashing indicator will alert the service technician.)

### 4. Emergency Indication:

Charging-Green light flashes slowly

Full charged-Green light ON

Analog Emergency Mode-Green light in breathing mode (On-off Alternation)

Fault-Red light flashes quickly

### 5. Warning:

- In order to prevent electric shock, do not connect the connection terminal of emergency power battery with AC power supply before installation.
- First connect the LED light board and check the positive and negative poles to avoid reverse connection.
- Connect the output terminal of the driving power supply to the emergency power supply after ensuring no error.
- Connect the AC power supply.
- When disassembling the product, first disconnect the AC power supply and unplug the battery, so as to avoid the risk of high-voltage burning out the LED drive or high-voltage electric shock caused by unplugging the lamp board in power emergency.
- After unplugging the battery, stay for 5 seconds, and then remove other circuits.

Technical Helpline +44 (0)1924 893380

www.belllighting.co.uk

British Electric Lamps Ltd  
Unit A Foxbridge Way, Normanton Industrial Estate  
Normanton, West Yorkshire. WF6 1TN

T: +44 (0)1924 893380 F: +44 (0)1924 894320 E: sales@belllighting.co.uk

www.belllighting.co.uk